



GLOBE Data Entry with GLOBE Observer

10/19/23

Cornell Lewis, Axient





Agenda

- GLOBE Observer App Features
- Selecting Protocols
- Creating Sites
- Reviewing and Sending Data
- Account Settings
- Before we go out
- Time to make measurements
- When we return

GLOBE Observer App

- GLOBE Observer
 - Clouds, Mosquitoes, Land Cover and Trees are the 4 “Observer protocols”
 - Easy to use
 - Any created account with a verified email can do these protocols
 - If you login with your GLOBE Teacher account, or your student accounts, the data you enter will be counted with your school.
 - GLOBE Eclipse is available as needed
- GLOBE Observer/Data Entry (Atmosphere, Biosphere and Hydrology)
 - Only available to trained users – ie teachers and their student accounts





GLOBE Observer - Features

- You don't need to create a site before you start entering data – the app will prompt you if necessary
- You can edit/delete sites and measurements
- You can enter clouds and other data and associate it with an existing school site
- You can have more than one person's account on a single phone
- There are matching data entry forms available through a web browser on desktop, laptop or chromebook:

<https://dataentry.globe.gov/>



GLOBE Observer - Features

- You can make your own “bundles” of protocols which you use frequently
- You can use GLOBE created bundles – Earth Systems bundles
- You can create and join GLOBE Teams
- Multiple languages available with more translations coming (and needed – especially the newer data entry forms)

“Old Data Entry”

- The existing data entry forms remain available: data.globe.gov.
- You can continue to use them for all Pedosphere protocols.
- The old data entry app is still available but is no longer maintained

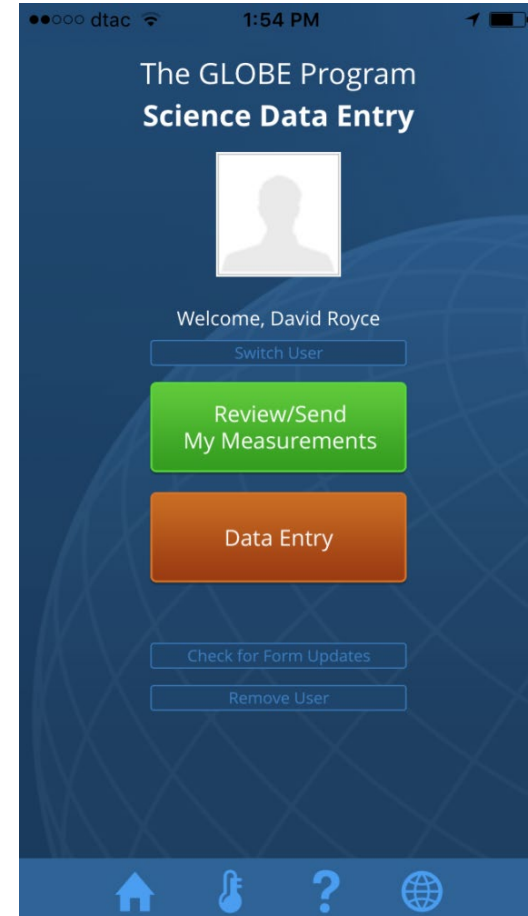

Observer Data Entry – Select Your protocols

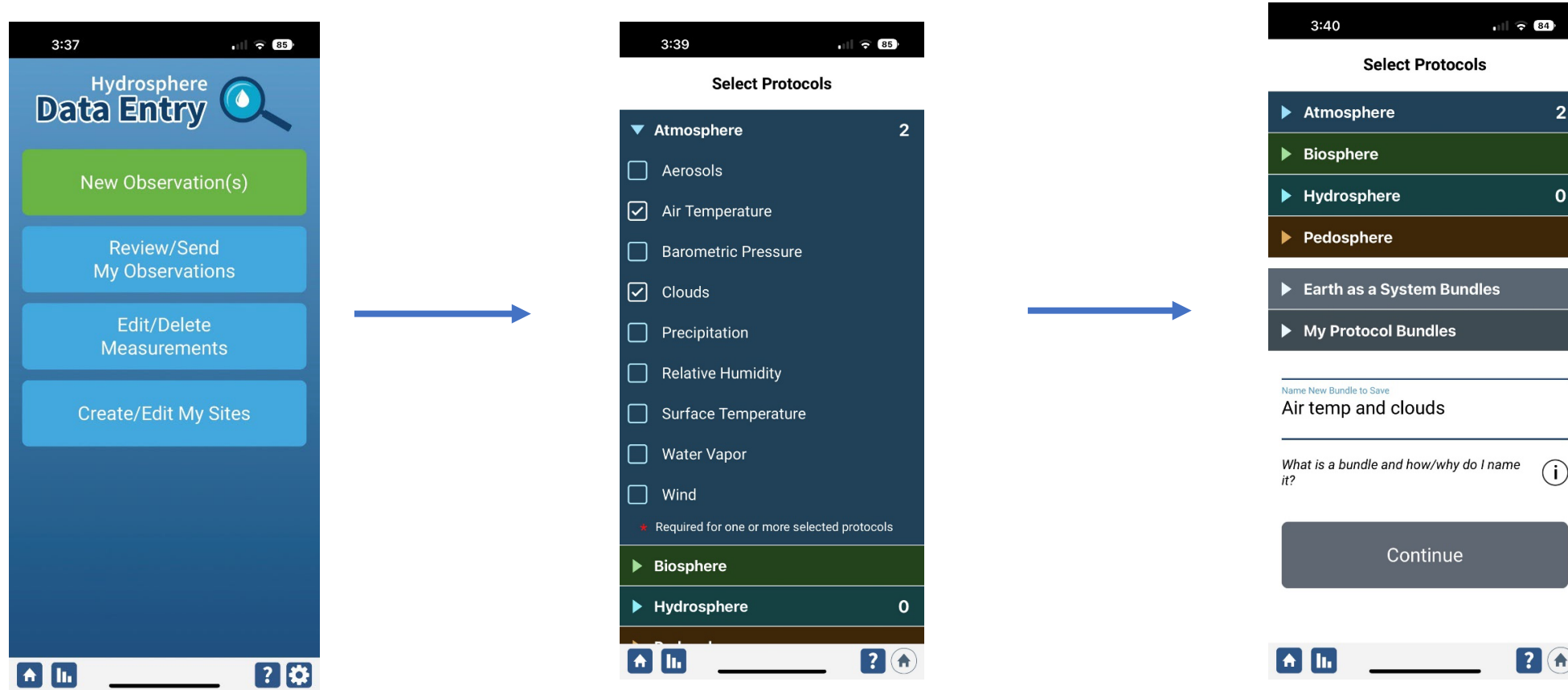



Choose/Create/Define your site and enter data

3:41

< Site Location

Latitude:
34.13243

Longitude:
-117.74241

Elevation:
469.2

Use 2 fingers to move map

Map Satellite

Name: Johnsons Pasture

Test atm site >

Johnsons Pasture >

Home List Home ?



3:43

< Air Temperature

Current Temperature (Celsius) *
21 °C

Comments

Review

Home List Home ?



3:41

< Site Location

Review Site fields:

Air Temperature

Thermometer Type: *
Thermometer Height (cm):
Obstacles:
Buildings:
Surface Cover:
Next

Home List Home ?

Review and Send Your Data

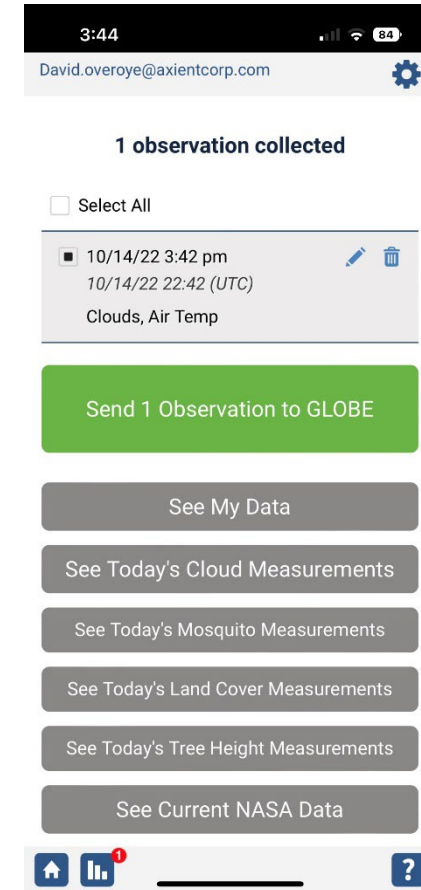
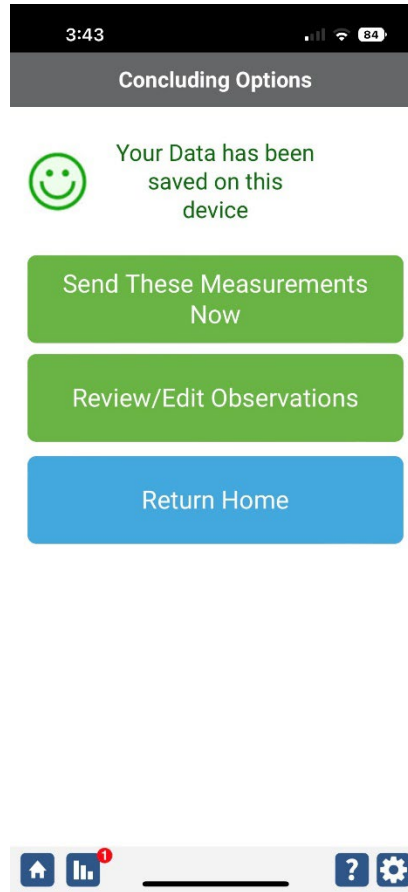
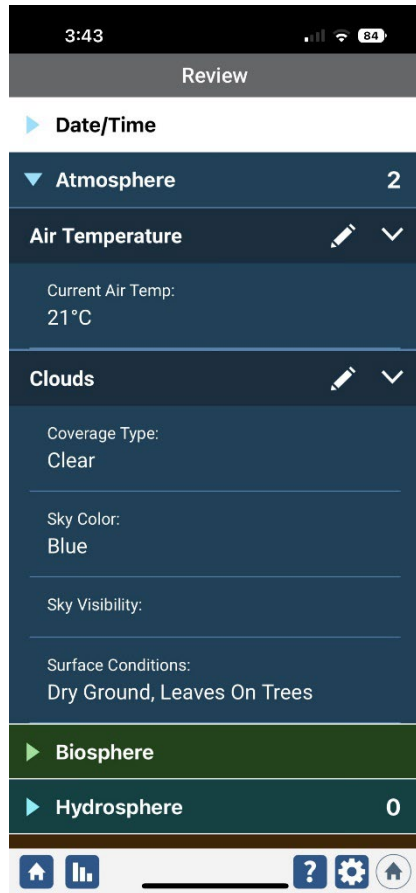

Account Settings

- Many options available in account settings
- Support for multiple accounts and switching accounts
- Language Options
- GLOBE Team options

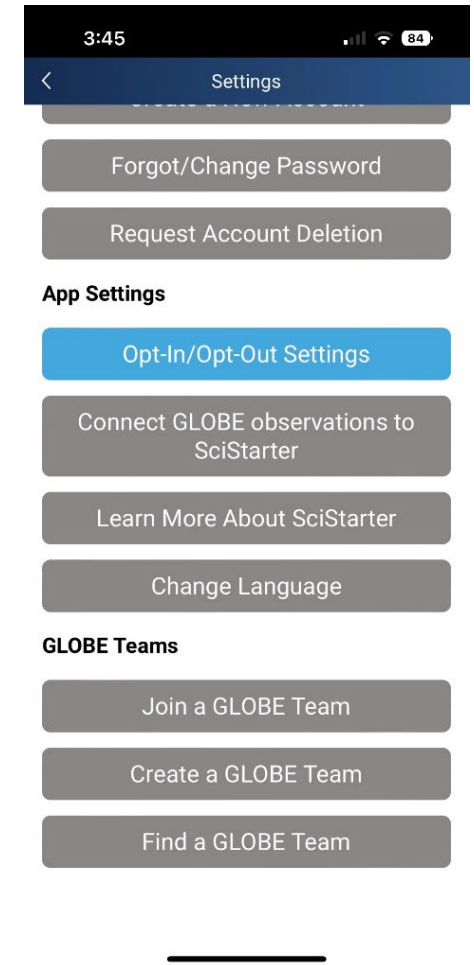
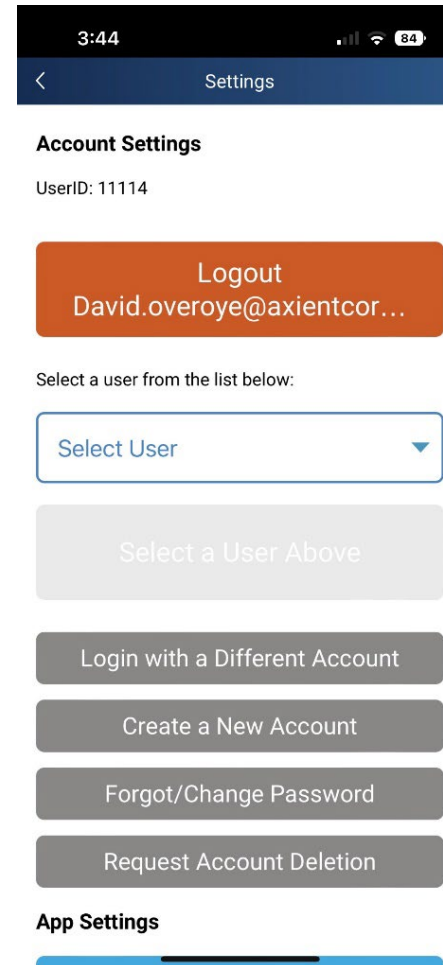



Before we go out

- Verify the GLOBE Observer app is downloaded and updated
- Verify you can login or create an account
- Launch your app and join the team I just created
 - <https://www.globe.gov/web/europe-2023-regional-meeting>
 - **Referral Code: GLIDJ7CV**
 - Once you've joined, check and see if your name or screen name is listed on the team page.
- Complete the tutorials for each protocol (clouds, trees) so you can see the home page for each observer protocol
- Verify you can see the “Data Entry” Option (trained users)



Time to Make Measurements

- Go through at least trees and clouds
- Trees – let's all measure the height of the same tree to see how consistent our measurements are
- Clouds – If you're trained, use the Data Entry/Atmosphere/Clouds instead of the Observer Clouds protocol

When we come back

- Check our team to see what data now appears
 - <https://www.globe.gov/web/europe-2023-regional-meeting>
- Look at 'My Observations' to see your data



When we come back

Retrieve the Data using ADAT: <https://datasearch.globe.gov/>

- Date Range: bracket today's date
- School / Teacher / Partner / Team: Europe 2023 Regional Meeting
- Protocols:
 - Trees
 - Clouds



When we come back

See the Data on the Vis Tool: <https://vis.globe.gov/>

- Measurement Date Range: today's date
- Protocols:
 - Tree Height
 - Tree Photos
 - Clouds
- Zoom into Latvia or filter by Latvia

GLOBE Observer and Data Entry Tutorials

- For additional training, visit the Tutorial Center to access the Data Entry Tutorials
- Training > Tutorial Center

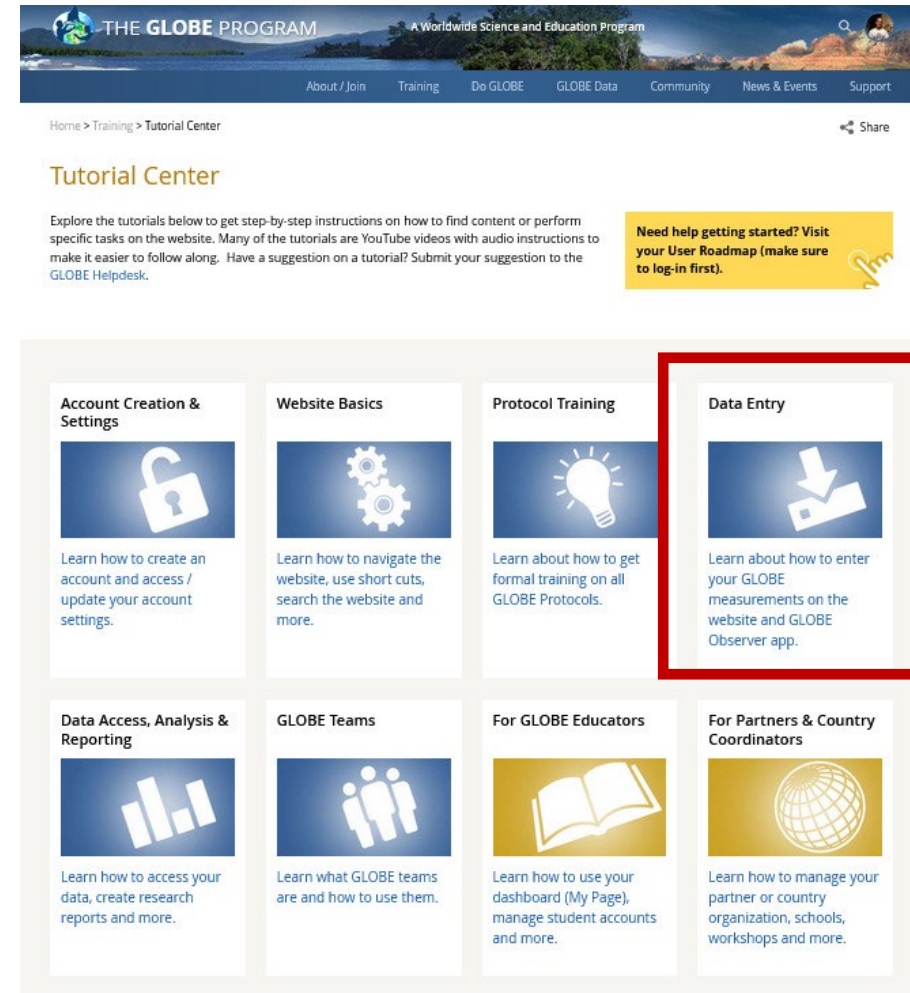

The screenshot shows the GLOBE Program website's Tutorial Center. The header includes the GLOBE logo and navigation links: About / Join, Training, Do GLOBE, GLOBE Data, Community, News & Events, and Support. The breadcrumb trail is Home > Training > Tutorial Center. The main heading is "Tutorial Center" with a sub-heading: "Explore the tutorials below to get step-by-step instructions on how to find content or perform specific tasks on the website. Many of the tutorials are YouTube videos with audio instructions to make it easier to follow along. Have a suggestion on a tutorial? Submit your suggestion to the GLOBE Helpdesk." A yellow callout box says: "Need help getting started? Visit your User Roadmap (make sure to log-in first)." Below this is a grid of eight tutorial categories, each with an icon and a brief description. The "Data Entry" category is highlighted with a red border. The categories are:

- Account Creation & Settings**: Learn how to create an account and access / update your account settings.
- Website Basics**: Learn how to navigate the website, use short cuts, search the website and more.
- Protocol Training**: Learn about how to get formal training on all GLOBE Protocols.
- Data Entry**: Learn about how to enter your GLOBE measurements on the website and GLOBE Observer app.
- Data Access, Analysis & Reporting**: Learn how to access your data, create research reports and more.
- GLOBE Teams**: Learn what GLOBE teams are and how to use them.
- For GLOBE Educators**: Learn how to use your dashboard (My Page), manage student accounts and more.
- For Partners & Country Coordinators**: Learn how to manage your partner or country organization, schools, workshops and more.



Remember – you can always use your browser

- Data entry is available on your browser on any device
- Data.globe.gov – original data entry forms
- Dataentry.globe.gov – new data entry forms



Questions?



The **GLOBE** Program

Contact Information

Cornell.Lewis@axientcorp.com

For more information visit www.globe.gov

Sponsored by:



Supported by:

